

For In Vitro Diagnostic Use.

NOTE: For use with BioFire Global Fever Special Pathogens Panel (DFA2-ASY-0018) and should not be used with any other kit.

REF DFA2-ASY-0019 IVD
Rx Only
CONTROL

Control Injection Vial



Positive External Control



Negative External Control

Materials required but not provided in control kit.

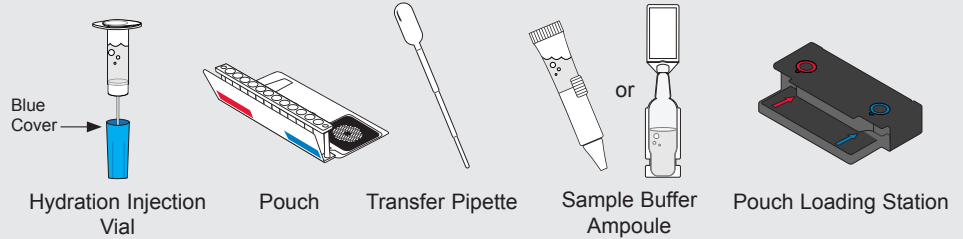

To avoid contamination, clean work area and always wear gloves.

Step 1: Prepare Pouch

- Insert pouch into Pouch Loading Station.
- Place Positive or Negative Control Injection Vial into **red well**.
- Place **Hydration Injection Vial** into **blue well**.

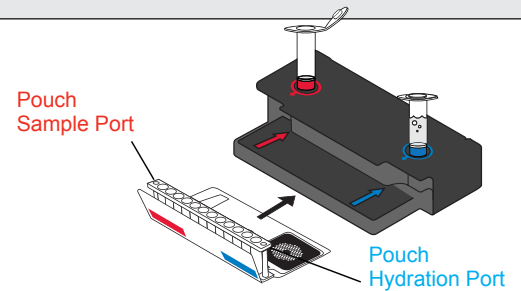

Step 2: Hydrate Pouch

- Unscrew **Hydration Injection Vial** from cover.
- Remove **Hydration Injection Vial**, leaving **blue cover** in Pouch Loading Station.
- Insert **Hydration Injection Vial** into **Hydration port**.
- Push down to puncture seal and wait as **Hydration Solution** is drawn into the pouch.

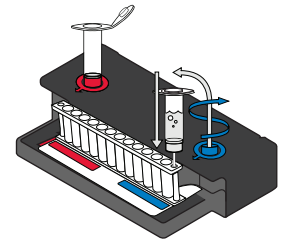

NOTE: Verify the pouch has been hydrated.

Step 3: Prepare External Control

Add Sample Buffer (NOTE: There are 2 possible designs of the Sample Buffer Ampoule)

- Hold the Sample Buffer Ampoule with the tip facing up.
NOTE: Do not touch the tip of the ampoule.
- Firmly pinch textured plastic tab on the side of the ampoule until the seal snaps **or** if there is no textured tab on the side, gently twist off the plastic tab on the tip.
- Dispense sample buffer into Control Injection Vial using a slow, forceful squeeze, followed by a 2nd squeeze.
NOTE: Avoid generating excessive foam.
- Tightly close lid and invert the Control Injection Vial **3** times.
- Return Control Injection Vial to **red well** of Pouch Loading Station.

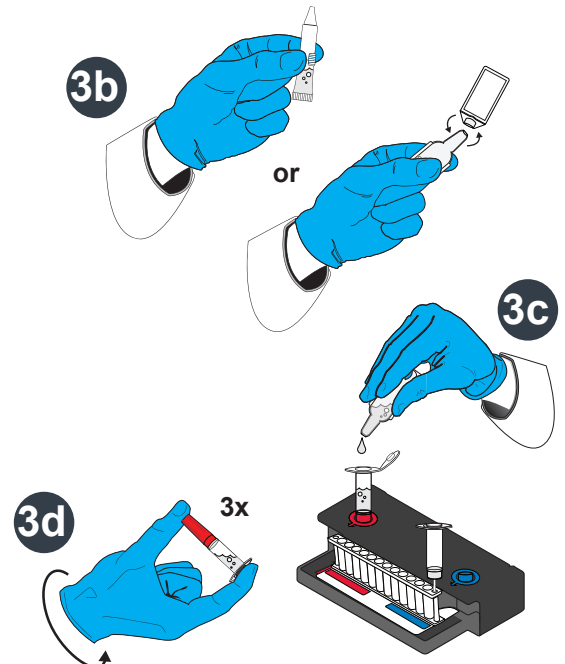

WARNING: Contact with sample buffer can cause serious eye damage and skin irritation and is harmful if swallowed.



Step 4: Load External Control

- Unscrew Control Injection Vial from **red cover**.
- Wait for **5** seconds, then remove Control Injection Vial, leaving **red cover** in Pouch Loading Station.
NOTE: Waiting **5** seconds decreases the contamination risk.
- Insert Control Injection Vial into **pouch sample port**.
- Push down to puncture seal, then wait as control material is drawn into the pouch.

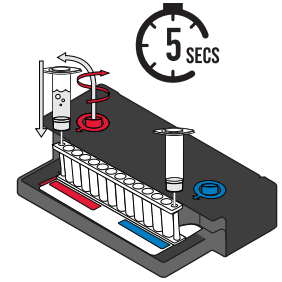

Step 5: Run Pouch

- Screw vials back into covers in Pouch Loading Station before disposing of them in a biohazard container.
 - Remove pouch from Pouch Loading Station and load into the instrument.
 - Follow instructions on screen for starting a test.
- NOTE:** Select either **Positive External Control** or **Negative External Control** protocol.

Step 6: Review Report

Run Information - Displays information about the sample, protocol, pouch, instrument, run status, results, and recommended action.

1 Internal Controls:

- If 'Passed', results are valid.
- If 'Failed' or 'Invalid', **RETEST EXTERNAL CONTROL** once.

2 Run Status:

- If 'Completed', run is complete.
- If 'Incomplete', 'Aborted', or any other error message, **RETEST EXTERNAL CONTROL** once.

3 External Control Results:

- If 'Passed', report the results.
- If 'Failed':
 - Positive External Control: **RETEST EXTERNAL CONTROL** once.
 - Negative External Control: Decontaminate the area and **RETEST EXTERNAL CONTROL** once.
- If 'Invalid', **RETEST EXTERNAL CONTROL** once.



BIOFIRE® SHIELD™ Positive External Control

GF Special Pathogens Panel

BIOFIRE

www.BioFireDefense.com

Run Information			
Sample ID	JW43822	Run Date	07 Apr 2023 12:00 AM
Protocol	Positive External Control v3.1	Serial No.	01234567
Pouch Type	GF SP Panel v1.0	Lot No.	012345
Internal Controls	Passed	Operator	Anonymous
Run Status	Completed	Instrument	FA0001

2

3

Passed

Report the Results

Result Summary	
Detected	Not Detected
<div>Bacillus anthracis</div> <div>Chikungunya virus</div> <div>Crimean-Congo hemorrhagic fever virus</div> <div>Dengue virus</div> <div>Ebola virus</div> <div>Francisella tularensis</div> <div>Lassa virus</div> <div>Leishmania spp.</div> <div>Leptospira spp.</div> <div>Marburgvirus</div> <div>Plasmodium spp.</div> <div>Plasmodium falciparum</div> <div>Plasmodium vivax/ovale</div> <div>West Nile virus</div> <div>Yellow fever virus</div> <div>Yersinia pestis</div>	

NOTE: Refer to the *BIOFIRE SHIELD Control Kit for the BioFire Global Fever Special Pathogens Panel Instructions for Use* for panel specific run reports and additional information. If repeated error messages are obtained, contact BioFire Defense Technical Support.